



Model TT-46 Mold Preheater

Tulsa Centrifugal Casting Machines, LLC



Minimize down time and increase production by preheating permanent steel molds. This "Off site" turntable can help eliminate thermal shock to the molds and prepare them for subsequent spraying of your centrifugal mold wash. No special foundation is required and with a slow rotating motion, the molds can be uniformly heated.

Model TT-46 Mold preheating turntable is designed to preheat Vertical axis permanent steel molds prior to actual production. With no special foundations required, the unit is designed and built of heavy construction. Variable speed drive unit with operators remote control, the speed of rotation can be easily adjusted.

Maximum Table Diameter: 46" (1168 mm)
Maximum Mold Height: : 46" (1168 mm)
Maximum Load: 2000 lbs
No special foundations required



Tulsa Centrifugal Casting Machines, LLC
P.O. Box 702751
Tulsa, OK 74170-2751
Main Office: 918-585-1400 Fax: 918-251-3310
Email: sales@centrifugalcasting.com
Web: www.centrifugalcasting.com

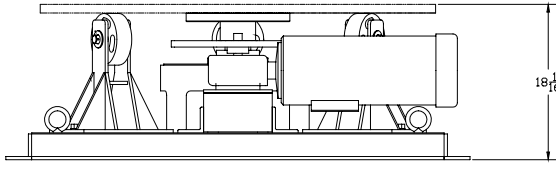
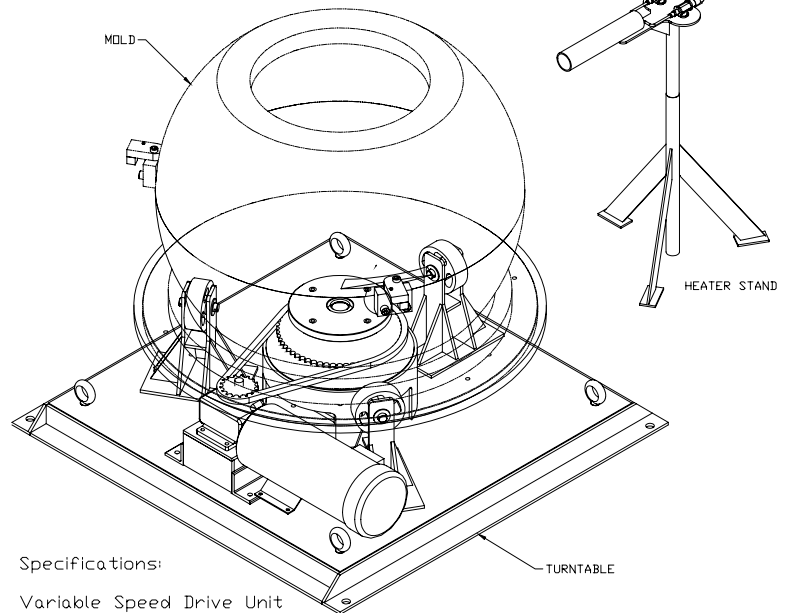
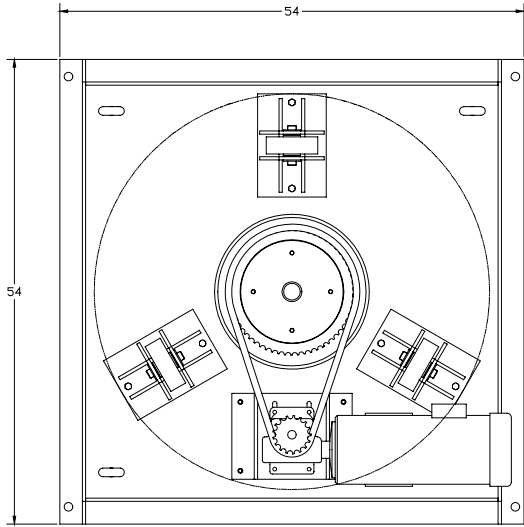

Specifications:

- Variable Speed Drive Unit
- Operator's Controls
- Maximum Table Dia: 46"
- Maximum Load: 2000 lbs

Adjustable Heater Stand
(Mold Heating Manifolds available)

